

# Hydraulic Toe Jack

## Instruction Manual



**⚠ WARNING:** Read the instruction manual carefully before using the appliance and follow all given instructions.

## Technical Parameter

Model	MHC-2.5RS	MHC-5RS	MHC-10RS	MHC-15RS	MHC-25RS
Top Capacity (lb.)	11000	22000	44000	66000	110000
Toe Capacity (lb.)	5500	11000	22000	33000	55000
Lowest Height of Toe (in.)	5/8	25/32	63/64	1-3/16	1-37/64
Highest Height of Toe (in.)	5-3/64	6-1/2	7-3/64	7-53/64	8-17/64
Lifting Height (in.)	4-17/32	5-53/64	6-7/32	6-7/32	6-7/32
Base Size L x W (in.)	8-5/64 x 5-33/64	9-41/64 x 7-31/64	11-1/32 x 8-5/64	12-13/64 x 9-41/64	13-25/64 x 11-1/32
Top Size L x W (in.)	1-31/32 x 2-3/4	3-5/32 x 3-15/16	3-35/64 x 5-1/8	4-9/64 x 4-59/64	4-59/64 x 5-45/64
Toe Size L x W (in.)	1-37/64 x 2-23/64	1-49/64 x 3-45/64	2-11/64 x 4-7/32	2-11/64 x 4-7/8	2-23/64 x 5-45/64
Overall Height (in.)	9-1/16	11-39/64	12-51/64	13-25/64	14-11/64
N.W. (lb.)	21	48.5	72.5	105	154

### CAUTION

- the machine should be placed steady before operation, avoid the swing, the jack must be use in firm and level surface, should not use in soft or sloping surface. Strictly prohibit heavy weight not put in stability operation, otherwise tilt situation will happen.
- heavy weight goods on the jack maintain in lower position as far as possible, strictly prohibited add load in supporting the weight.
- when falling down the heavy weight goods, please do not stop suddenly, otherwise jack will damage.
- keep the product clean, handle with care, do not crash, throw in anywhere.
- before using jack, please pay attention to add lubricating oil in rail.
- when finish using jack, take back piston rod,in order to ensure jack using life.

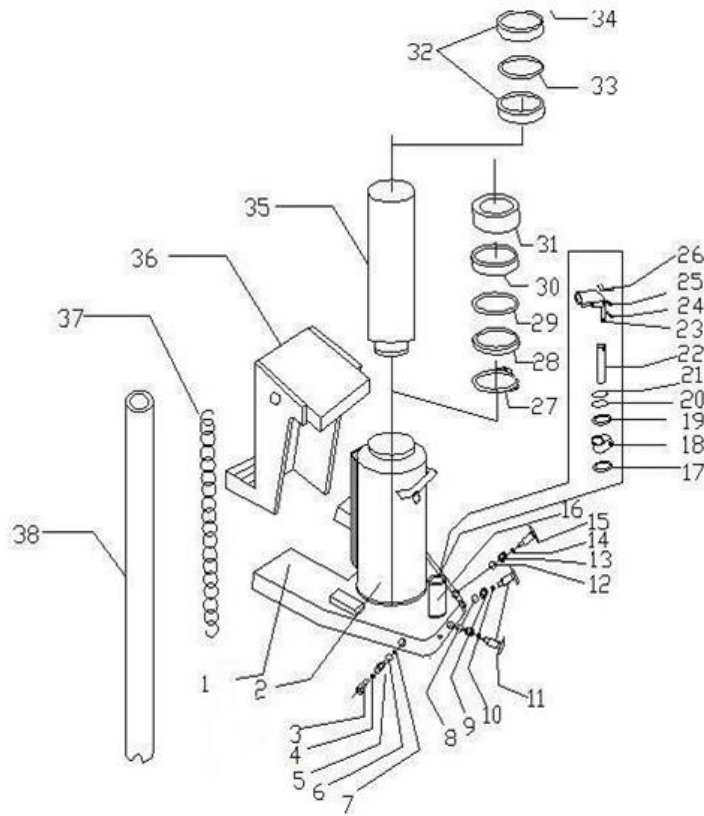

Number	Part Description	Quantity	Number	Part Description	Quantity
1	Baseboard	1	21	Pump Core O-Ring	1
2	Jack body	1	22	Pump Core	1
3	Relief Valve Screws	1	23	Handle socket	1
4	Relief Valve O-Ring	1	24	Fixed Bolt(Long)	1
5	Relief Valve Spring	1	25	Fixed Bolt(Short)	1
6	Ball Valve Seat	1	26	Open Bolt	1
7	φ4 Steel Ball	1	27	Washer on Shaft	1
8	φ5 Steel Ball	2	28	Gasket	1
9	Oil Absorption Spring	2	29	Plunger O-Ring	1
10	Oil Absorption O-Ring	2	30	Bowl Type Cushion	1
11	Oil Absorption Screws	2	31	Piston Ring	1
12	φ6 Steel Ball	1	32	Baffle Ring	1
13	Discharging Pressure Spring	1	33	Piston Rod O-Ring	1
14	Discharging Pressure O-Ring	1	34	Internal Circlip	1
15	Discharging Pressure Screws	1	35	Piston Rod	1
16	Pump Body	1	36	toe	1
17	Pump Body Gasket	1	37	Tension Spring	1
18	Support Circle Turn	1	38	Handle Rod	1
19	Pump Body Pressure Circle	1			
20	Nylon Block Circle	1			

## Main Parts of Toe Jack



### Operation Steps

#### Operating up the jack,work steps:

- 1、 stuck the handle rod in the drain oil valve.
- 2、 clockwise tighten the drain oil valve, be careful not to over-tighten.
- 3、 insert the handle rod in the handle holder.
- 4、 shake up and down the handle, jack can lever up.

#### Fall the jack,work steps:

- 1、 stuck the handle rod in the drain oil valve.
- 2、 counterclockwise unscrew the drain oil valve slowly, and then jack may fall.
- 3、 be careful not to screw out jack too fast, do not screw out drain oil valve in excess of 3 laps.